

# Club & Garden

Club ambient restaurant and bar, where to start the evening, taste a special cocktail and have an aperitif with view to Ponte Milvio. Club&Garden is the place where to spend a night attending the shows organised in the dedicated space, listening ambient music and tasting special food.

The shoeless garden is the magic place of ParcoMilvio, open during the day for visitors to relax and take the sun, and in the night for special intimate moment.

# CLUB & GARDEN

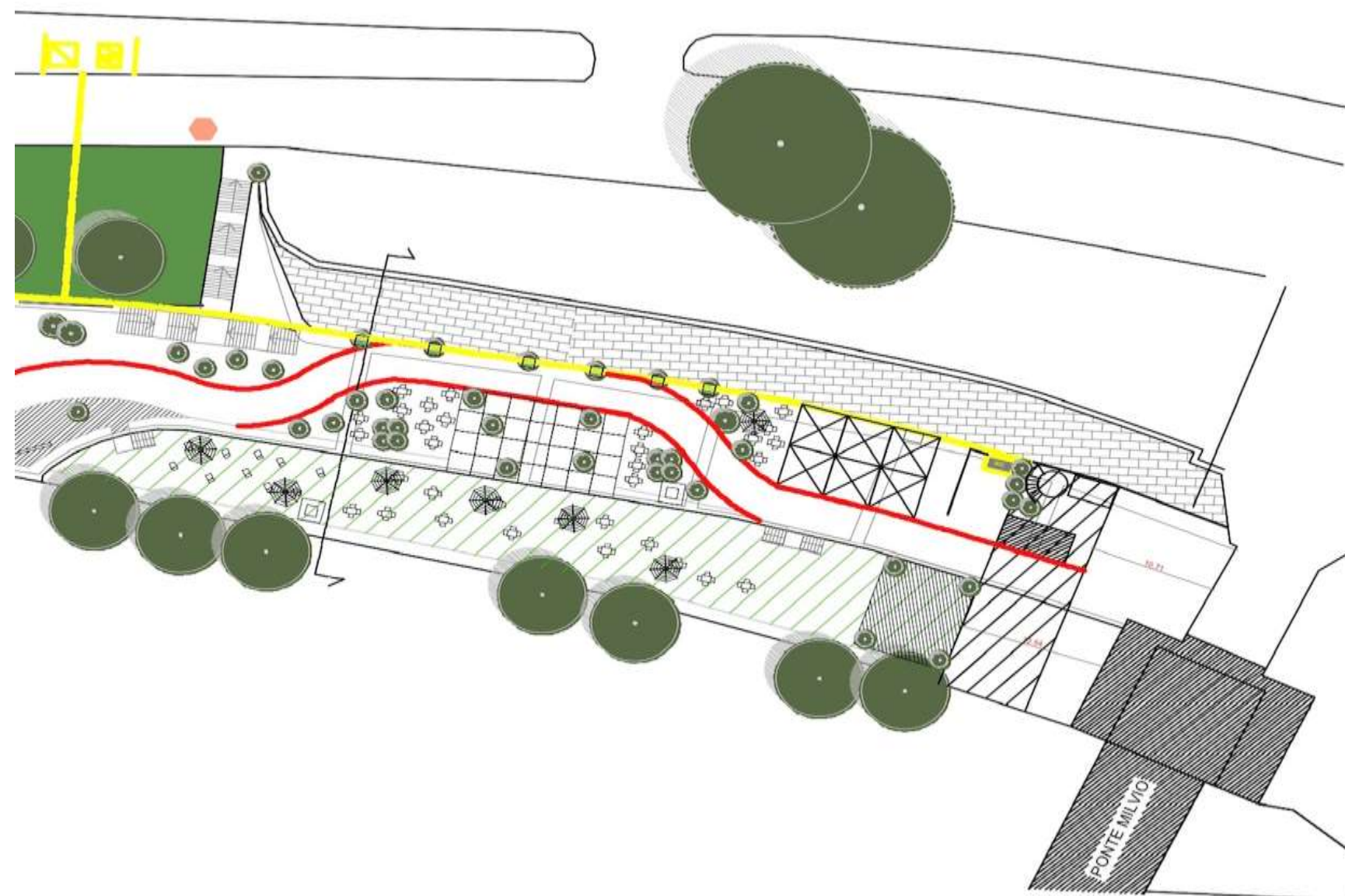

## Dimension and capacity

1.600 sqm

length: mt 80; width: min mt 19,4 e max mt 22,7

## Position

Located close to Milvio bridge, it has a unique and exclusive panorama. Easy to access to the other areas of the park.

## Main features

- dedicated access to the area and disable access from entrance n.2 of ParcoMilvio
- restaurant of n.6 commercial modules of 16 sqm each e spazio tavoli da 500 mq
- info point ed angolo *photo opportunity* con vista Ponte Milvio
- pedana in legno di circa 160 mq, con audio-video-luci per spettacoli
- giardino in erba naturale di circa 600 mq ed arredo verde su banchina con alberature, arbusti e vasi

## Contents

Free entrance shows, with music, theatre and talks, and audio-visual projections on the wall.

In the garden there will be activities promoting sports (ie. yoga) and green and nature.

## Infrastructure

- electrical system (max 15kw), water system and sewage - (till the commercial modules, no internal distribution)
- functional lighting
- entrance with large stairs in layher and driveway
- toilets and water points distributed along the dock
- irrigation system for the green